

DIMENSIONS

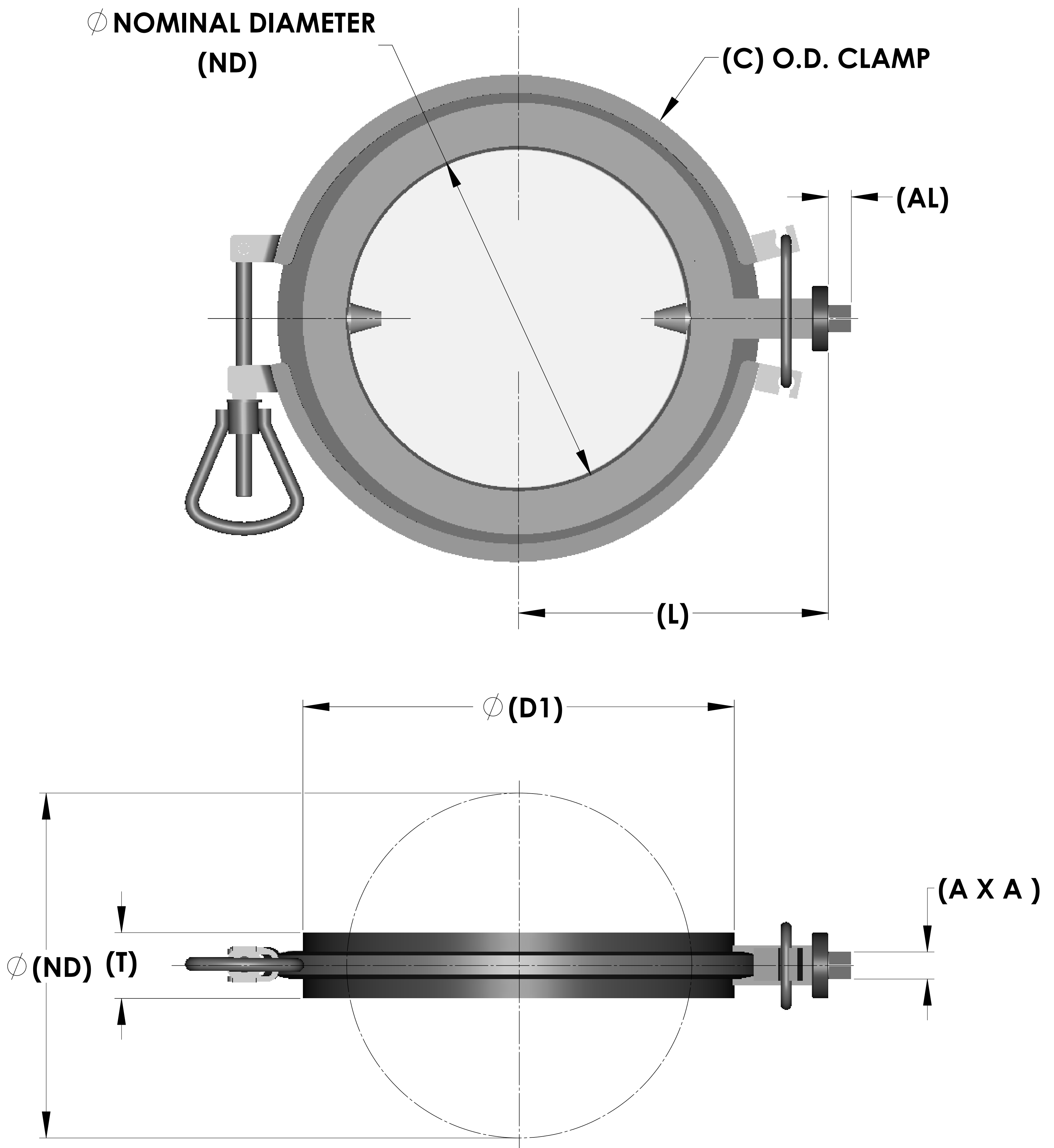

WEIGHTS SHOWN ARE WITHOUT OPERATING LEVER OR ACTUATOR

ND in. (mm)	D1	C	T	L	A X A	AL	WEIGHT lbs. (kg)
3" (80)	5.12 (130)	7.08 (180)	1.417 (36)	4.72 (120)	.433 □ (11)	.47 (12)	9.6 (4.4)
4" (100)	5.91 (150)	7.87 (200)	1.417 (36)	5.12 (130)	.433 □ (11)	.47 (12)	11.7 (5.3)
6" (150)	7.87 (200)	9.84 (250)	1.574 (40)	6.50 (165)	.551 □ (14)	.63 (16)	16.5 (7.5)
8" (200)	9.84 (250)	11.81 (300)	1.574 (40)	7.48 (190)	.551 □ (14)	.63 (16)	19.9 (9.1)
10" (250)	11.81 (300)	13.78 (350)	1.772 (45)	8.86 (225)	.669 □ (17)	.79 (20)	24.9 (11.3)
12" (300)	13.78 (350)	15.75 (400)	1.772 (45)	9.84 (250)	.669 □ (17)	.79 (20)	40.9 (18.5)

DIMENSIONS ARE SUBJECT TO CHANGE