

CORA® Model CV-V Ultra-Sanitary Butterfly Valve With Vibrating Feature

For intercepting and regulating the flow of powders



Construction:

- All product contact surfaces – 316L stainless steel
- Compression seal—FDA CFR 21 translucent silicone
- Shaft support bushings – PTFE Teflon
- Clamp band – 304 stainless steel
- Pneumatic actuator – anodized aluminum

Finish:

- Body & external #4 sanitary (Ra = 50 u-in.)
- Butterfly & internal #7 mirror (Ra = 20 u-in.)

Options:

- Hastelloy construction
- Seal materials – EPDM, Viton or PTFE
- Multiple mounting configurations to fit your needs

Available Sizes:

- 3" (80mm), 4" (100mm), 6" (150mm), 8" (200mm)
- 10" (250mm), 12" (300mm), 14" (350mm), 16" (400mm)

About CORA Ultra-Sanitary Valves

For over 30 years, Key International has been the proud manufacturer and distributor of CORA® Ultra-Sanitary Butterfly Valves, delumpers and accessories that are designed for controlling the flow of pharmaceutical and food grade powders. We offer a multitude of sizes and body configurations that allow for easy interfacing with your specific equipment connections.

LOOK TO KEY INTERNATIONAL FOR:

PROCESSING EQUIPMENT: Capsule Checkweighers - Capsule Fillers - Capsule Polishers - High Shear Mixers & Granulators - Homogenizers - Metal Detectors - Rotary Tablet Presses - Tablet & Capsule Inspection - Tablet Coaters - Tablet Dedusters - Tablet Friability Testers - Tablet Hardness Testers - CORA Butterfly Valves
PACKAGING EQUIPMENT: Blister Packaging - Bottle Cappers - Bottle Fillers - Bottle Inserters - Bottle Unscramblers - Cartoners - Form/Fill/Seal Pouch Fillers - Single Dose Pre-formed Plastic Shells - Stick Pack Packaging - Suppository Systems - Tablet & Capsule Counters - Tube Fillers

The original CORA CV sanitary valve has been taken to a new level of functionality by the addition of a pneumatic linear vibrator. When being discharged from an IBC, blender or other type of container, fine food grade/pharmaceutical powders can “bridge” and even stop flowing. The NEW CORA CV-V Valve reduces powder adhesion and increases the reliable flow by employing the effects of variable frequency vibrations.

Features:

- Supplied with a pneumatic positioner that allows for the disc to be opened to any position for control of the discharge
- Specifically designed for stringent FDA & USDA sanitary requirements
- Easy to detach, disassemble and thoroughly clean using a sanitary clamp band
- Slender profile for weight and space savings

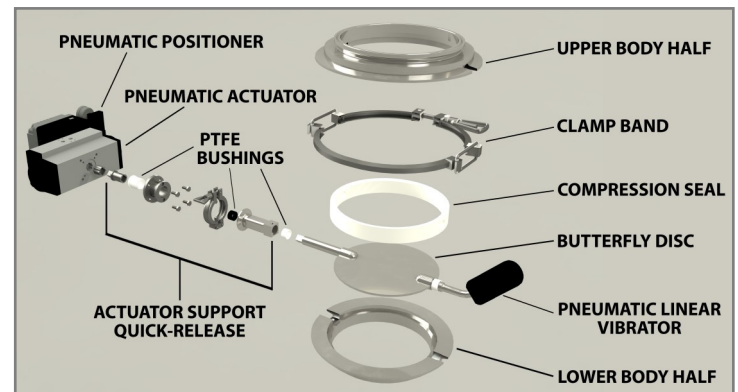

Exploded view of Model CV-V Valve with Pneumatic Actuator & Positioner